



ASPIRE

— TO MOVE —



Bedford Court, Bath, BA1

Video and physical viewings available. Two bedroom, two bathroom maisonette located in the popular Bedford Court development. The flat is offered furnished and is available from the 7th May. The flat benefits from a private parking space and communal garden.

Bedford Court is located just off London Road and provides excellent access into Bath city centre. There is a bus stop 0.1 miles away and local shops on London Road including a Morrisons supermarket 0.2 miles away.

- Video viewing available
- Offered furnished
- Professional sharers or couple
- Allocated parking space
- Communal riverside gardens
- Available 7th May
- Council tax band A
- Holding deposit: £300

£1,300 PCM

Floor Plans

FIRST FLOOR
357 sq.ft. (33.2 sq.m.) approx.

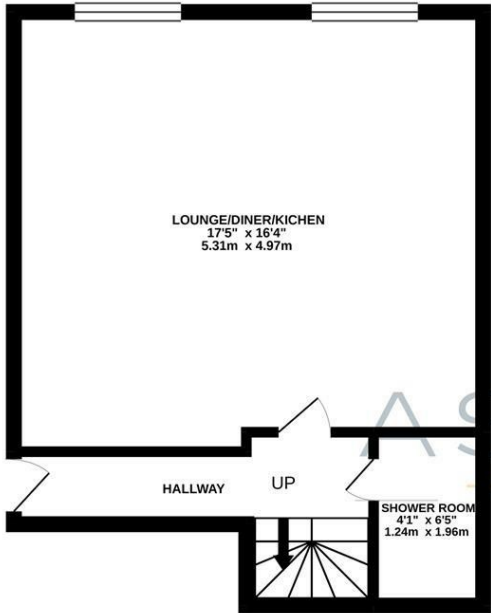

SECOND FLOOR
384 sq.ft. (35.6 sq.m.) approx.

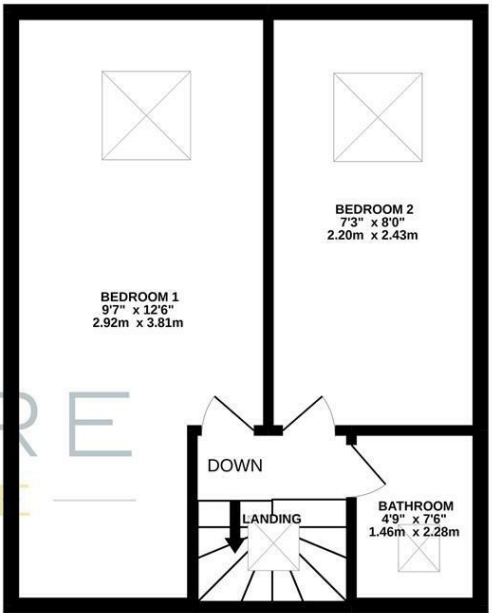

BEDFORD COURT

TOTAL FLOOR AREA : 741 sq.ft. (68.8 sq.m.) approx.

Whilst every attempt has been made to ensure the accuracy of the floorplan contained here, measurements of doors, windows, rooms and any other items are approximate and no responsibility is taken for any error, omission or mis-statement. This plan is for illustrative purposes only and should be used as such by any prospective purchaser. The services, systems and appliances shown have not been tested and no guarantee as to their operability or efficiency can be given.

Made with Metropix ©2020

Energy Performance Graph

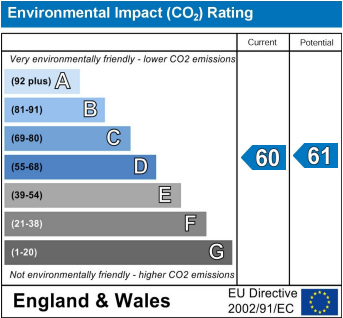
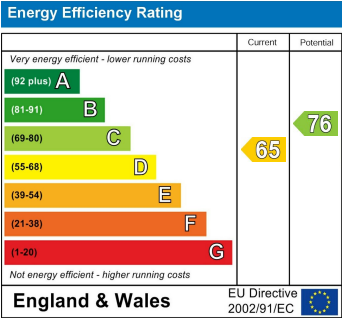

These particulars, whilst believed to be accurate are set out as a general outline only for guidance and do not constitute any part of an offer or contract. Intending purchasers should not rely on them as statements of representation of fact, but must satisfy themselves by inspection or otherwise as to their accuracy. No person in this firms employment has the authority to make or give any representation or warranty in respect of the property.